

# PEM ALL

## Discharge Nozzles



### Features

1/2, 3/4, 1, 1-1/4, 1-1/2, 2 Inch Sizes

180° and 360° Discharge Options

Large Area Coverage Capability

Aluminum Construction

UL Listed, FM Approved

ULC Pending

Discharge nozzles are 130° discharge pattern type and made of aluminum, with female pipe threads. Nozzle orifice sizes are determined by hydraulic flow calculations. All nozzles are rated for a maximum hazard height of 16 feet. If hazards exceed 16 feet in height, a second tier of nozzles must be used. Feed piping may be from top down or bottom up.

#### **Nozzle Selection—Sidewall 180°**

Typically to be installed adjacent to the center of the one wall of one enclosure. It's discharge path will be across the enclosure. At no time shall the area coverage be exceeded.

#### **Nozzle Selection—Central Type 360°**

Typically to be installed at the center of the enclosure. It's discharge path will be across the enclosure. At no time shall the area coverage be exceeded.

FM Approved—FM 2D3A4.AF

UL Approved—UL EX4668

# PEM ALL

**FIRE EXTINGUISHER CORPORATION**  
**A DIVISION OF PEM SYSTEMS INC.**

FIRE EXTINGUISHERS AND SPECIAL HAZARD SYSTEMS FOR ALL APPLICATIONS  
39A Myrtle Street, Cranford, New Jersey 07016-0586 • (908) 276-0211 • FAX (908) 276-8074

NOZZLE TYPE  
SIDEWALL 180°

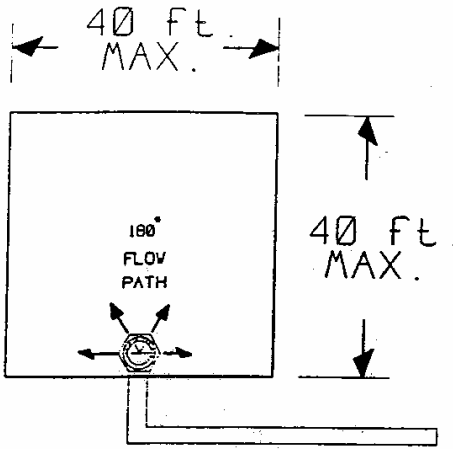
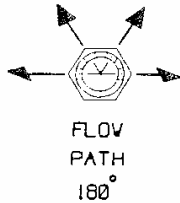

SIDEWALL 180°  
NOZZLE MAX AREA COVERAGE

NOZZLE TYPE  
CENTRAL 360°

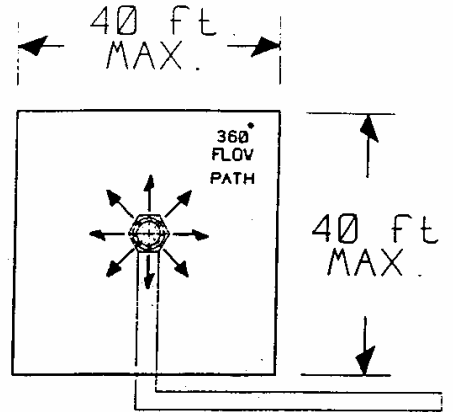
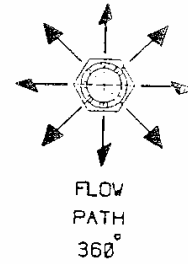

CENTRAL 360°  
NOZZLE MAX AREA COVERAGE

### NOZZLE NUMBERING SYSTEM

BASE PART NUMBER	NOZZLE TYPE	PIPE SIZE	DRILL DIAMETER RANGE
PCA60702-2	180	1/4	0.0625 TO 0.1285
PCA60702-3	360		
PCA60703-2	180	3/8	0.0625 TO 0.1730
PCA60703-3	360		
PCA60704-2	180	1/2	0.0670 TO 0.2187
PCA60704-3	360		
PCA60705-2	180	3/4	0.0935 TO 0.2900
PCA60705-3	360		
PCA60706-2	180	1	0.1200 TO 0.3680
PCA60706-3	360		
PCA60707-2	180	1-1/4	0.1562 TO 0.4844
PCA60707-3	360		
PCA60708-2	180	1-1/2	0.1800 TO 0.5625
PCA60708-3	360		
PCA60709-2	180	2	0.2340 TO 0.7188
PCA60709-3	360		

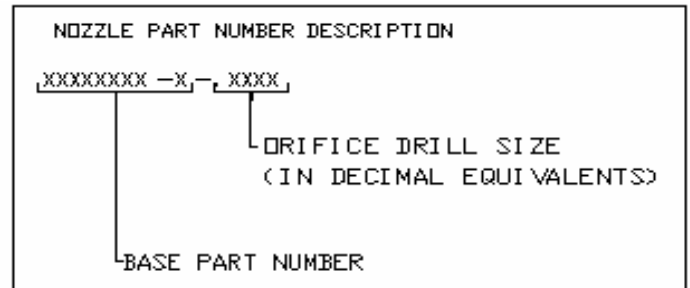

EXAMPLE:

PCA60705-2-, 2610

3/4 PIPE THREADS; 180 DEG. TYPE NOZZLE  
DRILLED TO 0.2610 SIZE DRIFICE.

### NOZZLE DRIFICE ORIENTATION

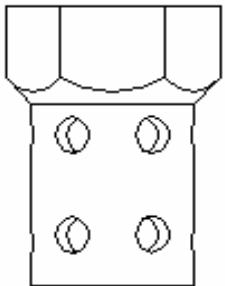

180 DEG.  
SIDE WALL

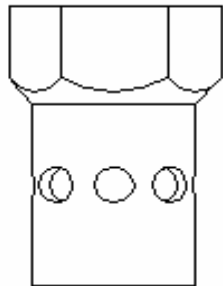

360 DEG.  
CENTRAL

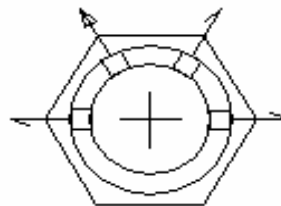

180 DEG.  
SIDE WALL

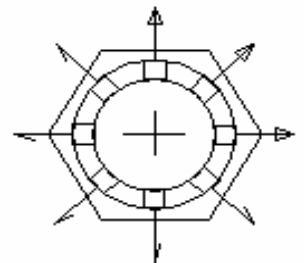

360 DEG.  
CENTRAL